

## TECHNIAL DRAWING

### DESSIN TECHNIQUE

Example of a 6'X44"section / Boards 5.375" / Spacers0.5"

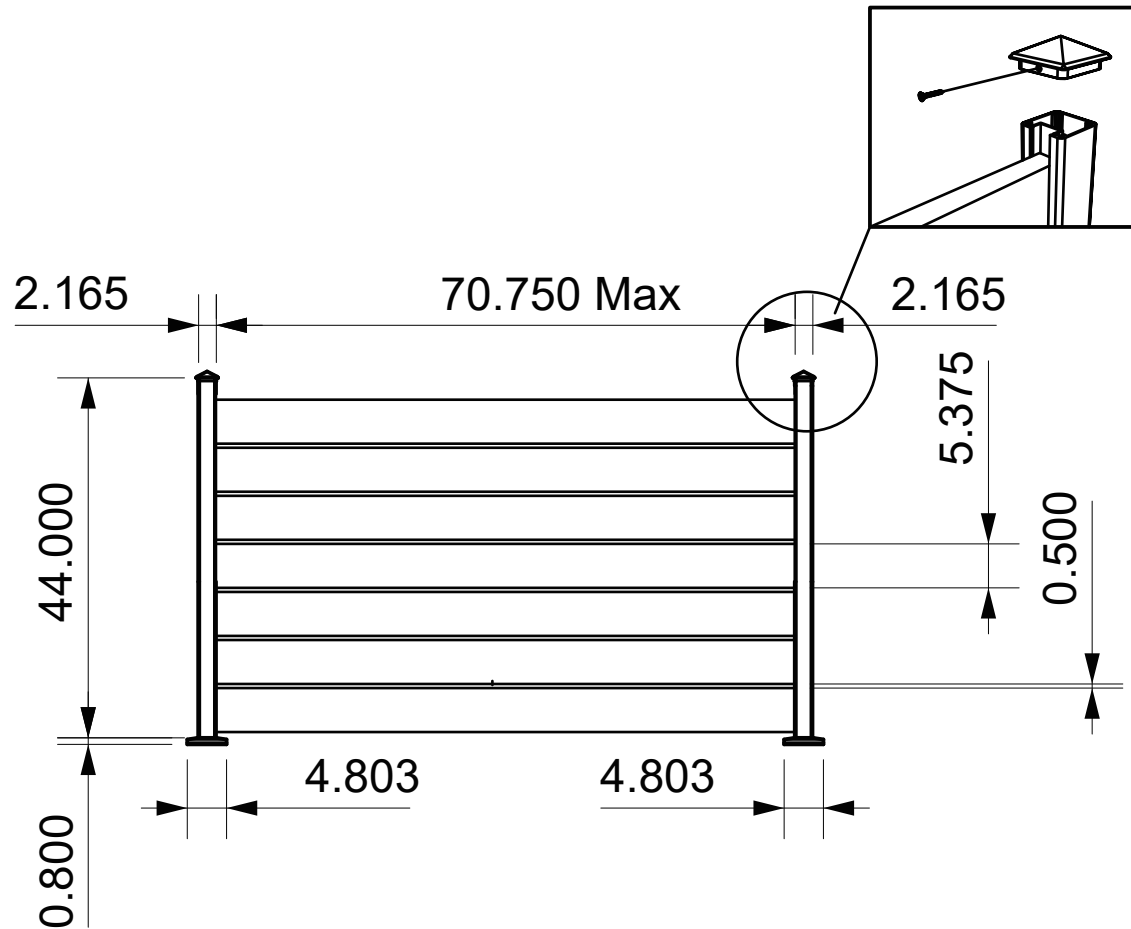

ALL POSTS WALL THICKNESSES ARE 2MM OR MORE

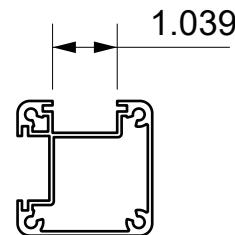
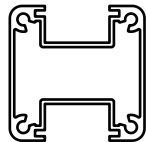
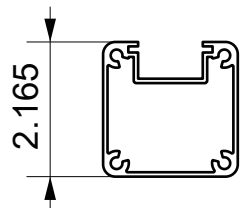

### Caution

1. All major components in the kit are aluminum and the anchor screws, etc. are stainless steel.
2. Make sure all columns are aligned and leveled, use wood, composite or cement anchoring screws to anchor columns.

*Patavin*  
ENJOY LIFE

info@patavin.com

www.patavin.com